

Order example

MGRC – **20** – **55** – **N**

Model
MGRC : Screw lock



Table width
MGRC (mm)

20	20
30	30
40	40

Table length
 25~155 mm
 (next table)

Width	Length
20	25, 35, 45, 55
30	65, 80, 95
40	105, 130, 155

Material
 – : Standard



B : Black coating

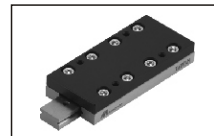

N : Antirust



S : Corrosion resisting



Material

Indicate Model	Table	Rail	Retainer	Roller
MGRC	Aluminum alloy+ Black anodized	SUJ2	SUS304	SUJ2
MGRC-N	S50C+Ni	SUJ2+Ni	SUS304	SUJ2
MGRC-B	S50C+Phosphate	SUJ2	SUS304	SUJ2
MGRC-S	SUS440C+Ni		SUS304	SUS440C

- **MGRC-N / MGRC-S** no finished to V-groove surface of the rail.
- **MGRC-S** table and rail are in one unit in this series.

- Table in **N** series, is antirust, apply to clean room environment.
- Table in **S** series, is antirust apply to corrosion-resisting, apply to clean room environment.
- Table in **B** series, is antirust, apply to clean room environment.
- All parts are cryogenic finished to increase 30% durability (refer to O-69).

SLIDE TABLE

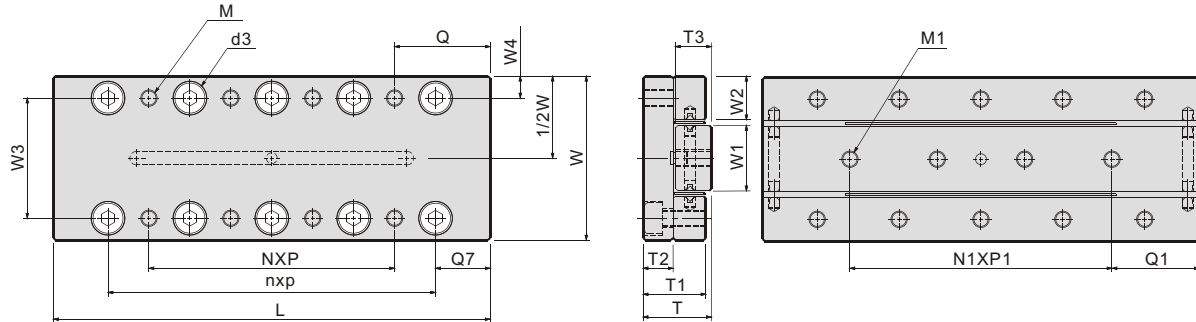

(mm)

Model	Max. stroke	Roller dia.	Main dimensions			Table mounting dimensions										Base mounting dimensions					
			W	T	L	W_3	W_4	$N \times P$	Q	M	$n \times p$	Q_7	d_3	T_1	T_2	W_1	W_2	$N_1 \times P_1$	Q_1	M_1	T_3
MGRC-20-25	12	$\phi 1.5$	$20^{+0.1}$	$8^{+0.1}$	25	14	3	1×18	3.5	M2.5	1×10	7.5	4.1	7.5	3.5	7	6.5	2×7.5	5	M2.5	4
MGRC-20-35	18				35			1×28			2×10										
MGRC-20-45	25				45			1×20			3×10										
MGRC-20-55	32				55			1×30			4×10										
MGRC-30-65	40	$\phi 2.0$	$30^{+0.1}$	$12^{+0.1}$	65	22	4	1×30	17.5	M3	3×15	10	6	11.5	5.5	12	9	3×15	10	M3	6
MGRC-30-80	50				80			1×45			4×15										
MGRC-30-95	60				95			2×30			5×15										
MGRC-40-105	60	$\phi 3.0$	$40^{+0.1}$	$16^{+0.1}$	105	30	5	1×50	27.5	M4	3×25	15	7.5	15.5	7.5	16	12	3×25	15	M4	8
MGRC-40-130	75				130			1×75			4×25										
MGRC-40-155	90				155			2×50			5×25										

Model	Basic dynamic load rating C(N)	Basic static load rating Co(N)	Allowable load Fu(N)	Static rated moment			Weight(kg)		Table moving accuracy (μm)	
				M_R (N.m)	M_P (N.m)	M_V (N.m)	Standard	Antirust	Center parallelism	Side parallelism
MGRC-20-25	523	865	288	2.2	2.6	2.2	0.02	0.03	2	4
MGRC-20-35	657	1,153	384	3.0	4.6	5.2	0.03	0.04		
MGRC-20-45	783	1,441	480	3.7	7.2	7.9	0.03	0.05		
MGRC-20-55	903	1,729	576	4.4	10.4	11.2	0.04	0.06		
MGRC-30-65	1,849	2,924	975	12.7	19.5	21.4	0.11	0.16	5	5
MGRC-30-80	2,407	4,093	1,364	17.7	38.2	35.5	0.13	0.20		
MGRC-30-95	2,672	4,678	1,559	20.3	49.9	46.8	0.16	0.24		
MGRC-40-105	5,646	10,655	3,552	61.8	124.3	133.2	0.31	0.48	3	6
MGRC-40-130	6,872	13,700	4,567	79.5	205.5	194.1	0.39	0.59		
MGRC-40-155	8,038	16,744	5,581	97.1	307.0	293.0	0.46	0.70		

● Each of load and torque changes oppositely in stroke variation.

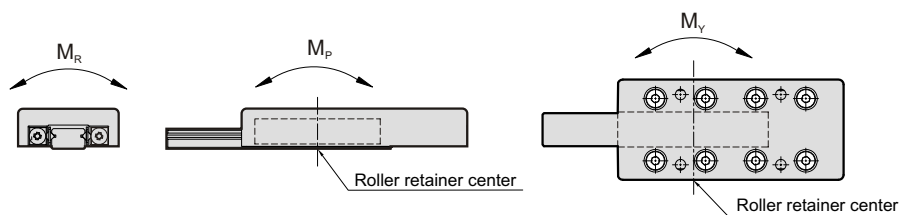

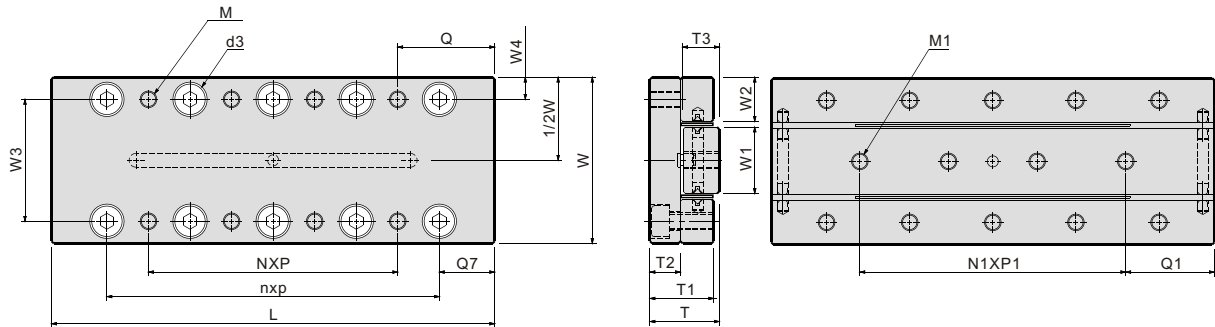

(mm)

Model	Max. stroke	Roller dia.	Main dimensions		Mounting dimensions												
			W	T	W ₃	W ₄	N×P	Q	M	n×p	T ₁	W ₁	W ₂	N ₁ ×P ₁	Q ₁	M ₁	T ₃
MGRC-20-25-S	12	φ 1.5	20 ^{±0.1}	8 ^{±0.1}	14	3	1×18	3.5	M2.5	1×10	7.5	7	6.5	2×7.5	5	M2.5	4
MGRC-20-35-S	18						1×28			2×10				2×10			
MGRC-20-45-S	25						1×20	3×10		3×10							
MGRC-20-55-S	32						1×30	4×10		4×10							
MGRC-30-65-S	40	φ 2.0	30 ^{±0.1}	12 ^{±0.1}	22	4	1×30	17.5	M3	3×15	11.5	12	9	3×15	10	M3	6
MGRC-30-80-S	45						1×45			4×15				4×15			
MGRC-30-95-S	50						2×30			5×15				5×15			
MGRC-40-105-S	18	φ 3.0	40 ^{±0.1}	16 ^{±0.1}	30	5	1×50	27.5	M4	3×25	15.5	16	12	3×25	15	M4	8
MGRC-40-130-S	30						1×75			4×25				4×25			
MGRC-40-155-S	40						2×50			5×25				5×25			

Model	Basic dynamic load rating C(N)	Basic static load rating Co(N)	Allowable load Fu(N)	Static rated moment			Weight (kg)	Table moving accuracy (μm)	
				M _R (N.m)	M _P (N.m)	M _V (N.m)		Center parallelism	Side parallelism
MGRC-20-25-S	523	865	288	2.2	2.6	2.2	0.03	2	4
MGRC-20-35-S	657	1,153	384	3.0	4.6	5.2	0.04		
MGRC-20-45-S	783	1,441	480	3.7	7.2	7.9	0.05		
MGRC-20-55-S	903	1,729	576	4.4	10.4	11.2	0.06		
MGRC-30-65-S	1,849	2,924	975	12.7	19.5	21.4	0.16		
MGRC-30-80-S	2,407	4,093	1,364	17.7	38.2	35.5	0.20		
MGRC-30-95-S	2,672	4,678	1,559	20.3	49.9	46.8	0.24	3	6
MGRC-40-105-S	5,646	10,655	3,552	61.8	124.3	133.2	0.47		
MGRC-40-130-S	6,872	13,700	4,567	79.5	205.5	194.1	0.58		
MGRC-40-155-S	8,038	16,744	5,581	97.1	307.0	293.0	0.70		

● Each of load and torque changes oppositely in stroke variation.

