

Features

- ISO-6432 standard.
- Stainless steel rod and tube for good corrosion resistance.
- Comprehensive types of mounting accessories available.
- Hexagonal rod design provides rod non-rotation function.

Specification

Model	MCKMI			
Tube I.D. (mm)	16	20	25	
Port size	M5×0.8	G1/8		
Medium	Air			
Operating pressure range	0.06~0.7 MPa			
Proof pressure	1 MPa			
Lubricator	Not required			
Ambient temperature	-5°C~+60°C (No freezing)			
Available speed range	50~500 mm/sec			
Max. allowable kinetic energy (J)	Cushion pad	0.09	0.27	0.4
	Cushion air	—	0.66	0.97
Rod non-rotating accuracy	±1°	±0.7°		
Allowable rotational torque	0.4 kgf-cm	2.0 kgf-cm	2.5 kgf-cm	
Sensor switch (band) (*1)	RCM(BM16)	RCM(BM20)	RCM(BM25)	

Table for standard stroke

Tube I.D.	Stroke (mm)
ø16	15,25,50,75,100,125,150,200
ø20,25	15,25,50,75,100,125,150,200,250,300

- Please consult us if stroke out of specification.

Tightening torque

Tube I.D.	Rod thread	Tightening torque (kgf-cm)
ø16	M6×1.0	41
ø20	M8×1.25	100
ø25	M10×1.25	190

* Make sure the tightening torque of rod thread does not exceed the value above.

* The tolerance of tightening torque is ±5%.

Order example

MCKMI — 11 — 20 — 100 — A — N

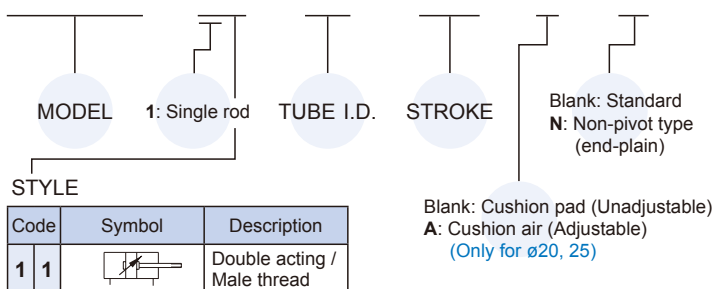

Cylinder weight

Unit: g

Model	Basic weight MCKMI	Stroke 25mm MCKMI	Basic weight MCKMI*-N	Stroke 25mm MCKMI*-N
Tube I.D.				
ø16	69	13.0	62	13.0
ø20	126	20.3	116	20.3
ø25	168	28.7	153	28.7

Mounting accessories

FA — MCKMI — 20

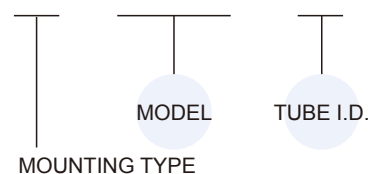

MOUNTING TYPE	Code
	LB
	FA
	FB
	SDB
	Y
	I
	YS (Y+Floating pin)

* Use the same accessories with MCKMI.

* Y, I, YS, please refer to page 3-13.

Cushion pad Unadjustable

ø16, ø20

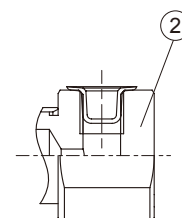
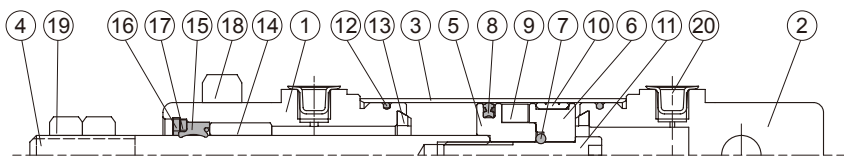

ø25

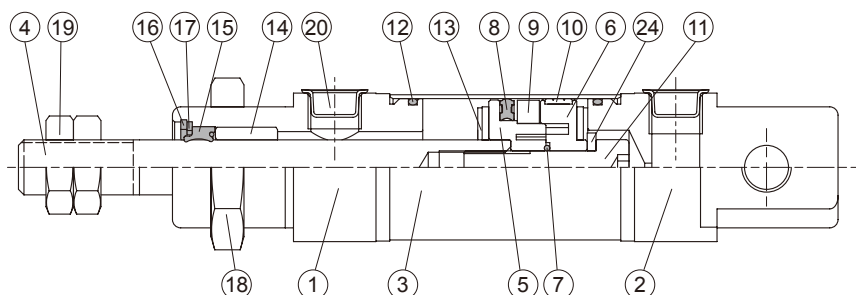

N type

Cushion air Adjustable

ø20, ø25

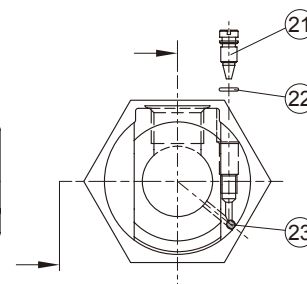
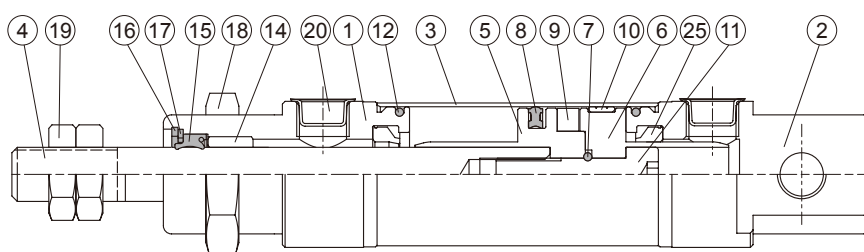

Material

No.	Cushion		Part name	Tube I.D.			Q'y
	Pad	Air		16	20	25	
1	●	●	Rod cover	Aluminum alloy			1
2	●	●	Head cover	Aluminum alloy			1
3	●	●	Tube	Stainless steel			1
4	●	●	Piston rod	Stainless steel			1
5	●	●	Piston-R	Aluminum alloy			1
6	●	●	Piston-H	Aluminum alloy			1
7	●	●	Piston gasket	NBR			1
8	●	●	Piston packing	NBR			1
9	●	●	Magnet ring	Magnet material			1
10	●	●	Wear ring	Teflon+Graphite			1
11	●	●	Piston bolt	SCM			1
12	●		Cover ring	NBR			2
13	●	●	Cushion gasket	NBR	TPU		2
14	●	●	Rod bush	Bearing alloy			1

No.	Cushion		Part name	Tube I.D.			Q'y
	Pad	Air		16	20	25	
15	●	●	Rod packing	NBR			1
16	●	●	Snap ring	Spring steel			1
17	●	●	Washer	Carbon steel			1
18	●	●	Tie nut	Carbon steel			1
19	●	●	Rod front nut	Carbon steel			2
20	●	●	Port plug	Plastic			2
21		●	Needle valve	Stainless steel			2
22		●	Needle valve packing	NBR			2
23		●	Steel ball	Stainless steel			2
24	●		washer	—		*	1
25		●	Cushion packing	NBR			2

* Carbon steel

11

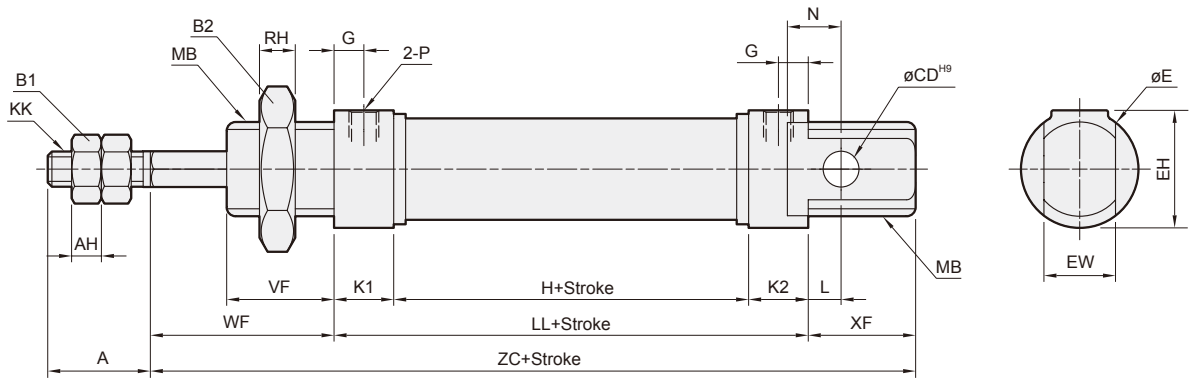

N

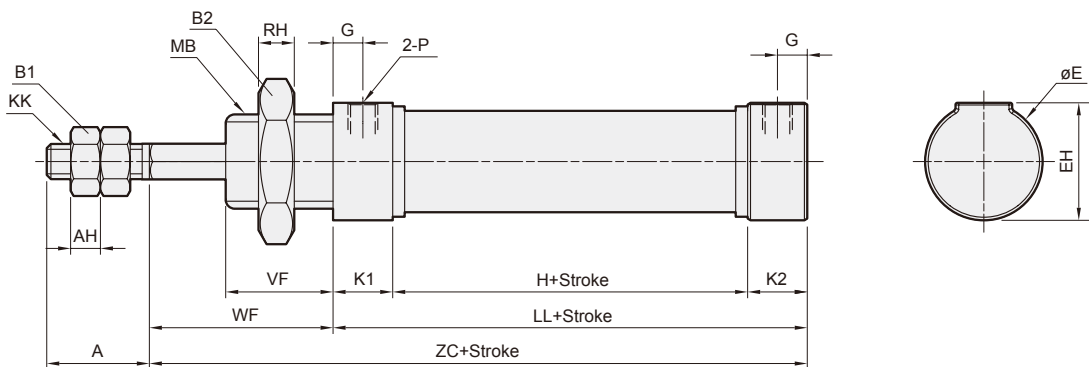

Code Tube I.D.	A	AH	B1	B2	CD	E	EH	EW	G	H	KK	K1	K2	L	LL	MB	N	P	RH	VF
16	16	5	10	22	6	20	20	12 ^{-0.05} _{-0.4}	5	34.5	M6×1	10	10	5.5	54.5	M16×1.5	9	M5×0.8	6	18
20	20	5	13	30	8	27	27	16 ^{-0.05} _{-0.4}	8	38	M8×1.25	15	15	3	68	M22×1.5	12	G1/8	6	20
25	22	5	17	30	8	27	27	16 ^{-0.05} _{-0.4}	7.5	37	M10×1.25	15	15	9	67	M22×1.5	12	G1/8	6	22

Code Tube I.D.	WF	XC	XF	ZC
16	22	76.5	18	94.5
20	24	92	20	112
25	28	95	22	117