

MAF302 series

AIR UNIT (FILTER)

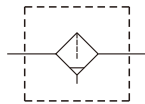

Symbol



Specification

Model	MAF302		
Bore No.	8A	10A	15A
Port size	1/4	3/8	1/2
Medium	Air		
Operating pressure range (*)	0.05~1 MPa		
Proof pressure	1.5 MPa		
Ambient temperature	- 5~+60°C (No freezing)		
Filter element	Standard: 5µm, Option: 40µm		
Drain capacity	35 cm ³		
Weight	335 g		

* Standard unit contains semi-auto-drain function when operating pressure below 0.05 MPa.

* Choose auto-drain FMRF300, the pressure range is 0.15~1 MPa.

Order example

MAF302 – 8A – D – □ – □ – □

MODEL

PORT SIZE

8A: 1/4
10A: 3/8
15A: 1/2

FILTER ELEMENT

Blank: 5µm
40u: 40µm

PORT THREAD

Blank: Rc thread
G: G thread
NPT: NPT thread

Blank: PC bowl + Semi-auto drain
D: Auto drain valve (FMRF300)
N: Nylon bowl

Blank: Without bracket
B: C type bracket

Flow feature

8A

Primary pressure
0.7 MPa

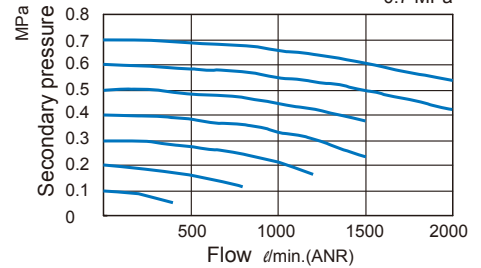

10A, 15A

Primary pressure
0.7 MPa

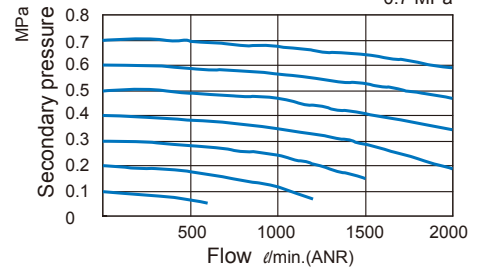

MAF302-D

Auto drain valve

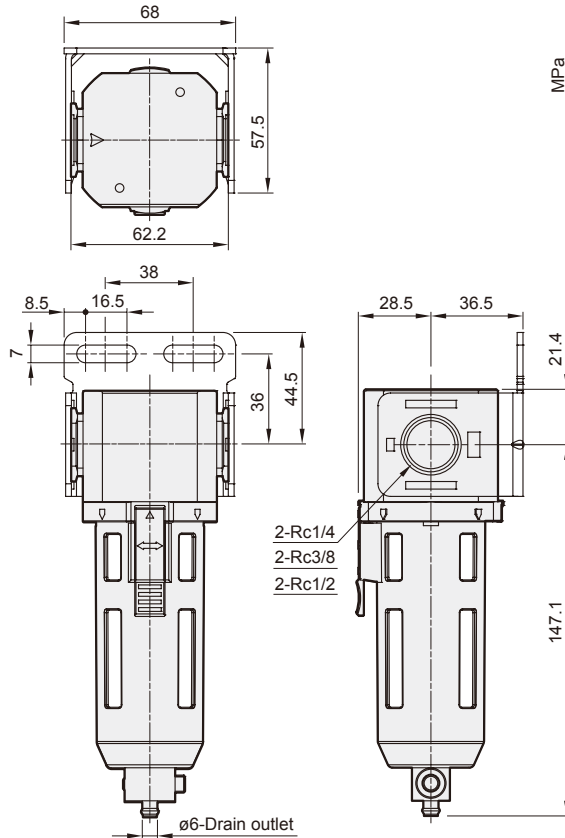
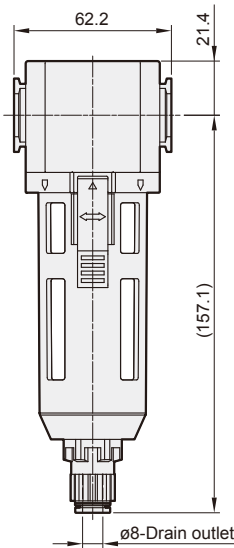

Option accessories

C type bracket

