

3/2-way Solenoid Valve for pneumatics



Type 6526 can be combined with...



Type 2506
Cable plug



Type 2510/2511
ASI cable plug

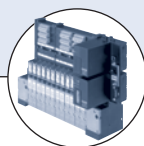

Type 8640
Valve island



Type 2031
Diaphragm valve

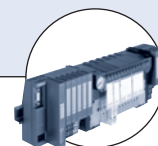

Type 8644
Valve island

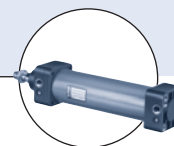

Type 0044
Pneumatic cylinder

- Compact design
- Single and manifold mounting
- Low power consumption
- Rocker pilot in DC
- Fast response times

The solenoid valve Type 6526 consists of a pneumatic valve body fitted with Type 6106 rocker pilot valve.

The rocker principle allows switching of high pressures together with low power consumption and fast response times. The extendable Type 6527 can be used for block modules (tag connectors in front) or for entire valve islands (8640 & 8644 - tag connectors at the block).

All valves are equipped with manual override as a standard.

| Technical data | |
|------------------------------|---|
| Orifice | DN 6.0 |
| Body material | PA (Polyamide) |
| Seal material | NBR |
| Media | Lubricated and non-lubricated dry air; neutral gases (10 µm filtering) |
| Media temperature | -10 to +50 °C |
| Ambient temperature | -10 to +55 °C |
| Manual override | As a standard feature |
| Port connection | Flange for MP12 |
| Pneumatic module | Type MP12 with G1/8, Push-in connection Ø 8 mm |
| Voltage tolerance | ±10% |
| Voltage | 24 V DC |
| Nominal power | 2W, 1W |
| Duty cycle | Continuous operation (100% ED) |
| Electrical connection | Tag connector acc. to DIN EN 175301-803 (previously DIN 43650) Form C Type 2506 |
| Protection class | IP 65 (with cable plug) |
| Weight | 85g |
| Mounting | with 2 screws M3x30 |
| Installation | As required, preferably with actuator upright |

Ordering chart for valves

3/2-way solenoid valve without cable plug

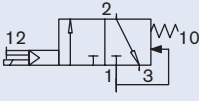
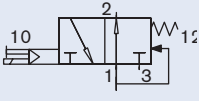
| Circuit function | Orifice [mm] | Q _{Nn} value air [l/min] | Pressure range [bar] | Power consumption [W] | Response times | | Item no. 24 V DC |
|---|--------------|-----------------------------------|------------------------|-----------------------|----------------|----------------------------|---------------------------|
| | | | | | Opening [ms] | Closing [ms] ⁴⁾ | |
| C 3/2-way valve  | 6 | 700 | 1.0 - 10 ¹⁾ | 2 | 20 | 12 | 156 842 ³⁾ |
| | | | 1.0 - 10 ¹⁾ | 2 | 20 | 12 | 163 028 ^{2), 3)} |
| | | | 2.0 - 10 | 2 | 20 | 12 | 156 318 ³⁾ |
| | | | 2.0 - 10 | 2 | 20 | 12 | 158 944 ^{2), 3)} |
| | | | 2.0 - 10 | 2 | 20 | 12 | 160 405 ^{2), 4)} |
| | | | 2.0 - 8.0 | 1 | 20 | 17 | 156 840 ³⁾ |
| | | | 2.0 - 8.0 | 1 | 20 | 12 | 158 947 ^{2), 3)} |
| | | | 2.0 - 8.0 | 1 | 20 | 12 | 160 408 ^{2), 4)} |
| D 3/2-way valve  | 6 | 700 | 1.0 - 10 ¹⁾ | 2 | 12 | 20 | 157 672 ³⁾ |
| | | | 1.0 - 10 ¹⁾ | 2 | 20 | 12 | 163 029 ^{2), 3)} |
| | | | 2.0 - 10 | 2 | 12 | 20 | 156 320 ³⁾ |
| | | | 2.0 - 10 | 2 | 20 | 12 | 158 946 ^{2), 3)} |
| | | | 2.0 - 10 | 2 | 20 | 12 | 160 407 ^{2), 4)} |
| | | | 2.0 - 8.0 | 1 | 17 | 20 | 156 841 ³⁾ |
| | | | 2.0 - 8.0 | 1 | 20 | 12 | 158 948 ^{2), 3)} |
| | | | 2.0 - 8.0 | 1 | 20 | 12 | 160 409 ^{2), 4)} |

¹⁾ Version with auxiliary pilot air.

²⁾ Electrical connection above manual override.

³⁾ "long version": can be mounted together with type 6527 on a valve island.

⁴⁾ In combination with valve islands the closing time will be approx. 5ms longer.

Flow rate, Q_{Nn}-value air [l/min]: Measured at +20°C, 6 bar pressure at valve inlet and 1 bar pressure difference

Pressure values [bar]: Measured as overpressure to the atmospheric pressure

Response times [ms]: Measures acc. to ISO 12238

Please note that the cable plug has to be ordered separately, see ordering chart for accessories on last page or separate datasheet for Type 2506.

Ordering chart for accessories: Type MP12 pneumatic modules

| Module | Version | Feature | Item no. | |
|---------------------------------|---------------------------------|--|--|---------|
| Connection module | right | G 3/8 | 655 110 | |
| | | NPT 3/8 | 655 112 | |
| | left | G 3/8 | 655 109 | |
| | | NPT 3/8 | 655 111 | |
| Pneumatic basic module 2 valves | push-in connection Ø 8 mm | without check valve | 156 617 | |
| | | with integrated check valve with R-channel | 156 635 | |
| | | with integrated check valve with R and S-channel | 156 632 | |
| | | connection G 1/8 | without check valve | 156 620 |
| | | | with integrated check valve with R-channel | 156 636 |
| | | | with integrated check valve with R and S-channel | 156 633 |
| | connection NPT 1/8 | without check valve | 156 631 | |
| | | with integrated check valve with R-channel | 156 637 | |
| | | with integrated check valve with R and S-channel | 156 634 | |
| | Pneumatic basic module 4 valves | push-in connection Ø 8 mm | without check valve | 156 656 |
| | | | with integrated check valve with R-channel | 156 662 |
| | | | with integrated check valve with R and S-channel | 156 659 |
| connection G 1/8 | | | without check valve | 156 657 |
| | | | with integrated check valve with R-channel | 156 663 |
| | | | with integrated check valve with R and S-channel | 156 660 |
| NPT 1/8 | | without check valve | 156 658 | |
| | | with integrated check valve with R-channel | 156 664 | |
| | | with integrated check valve with R and S-channel | 156 661 | |
| Covering plate | | | for unused valve positions | 653 765 |

Dimensions [mm]

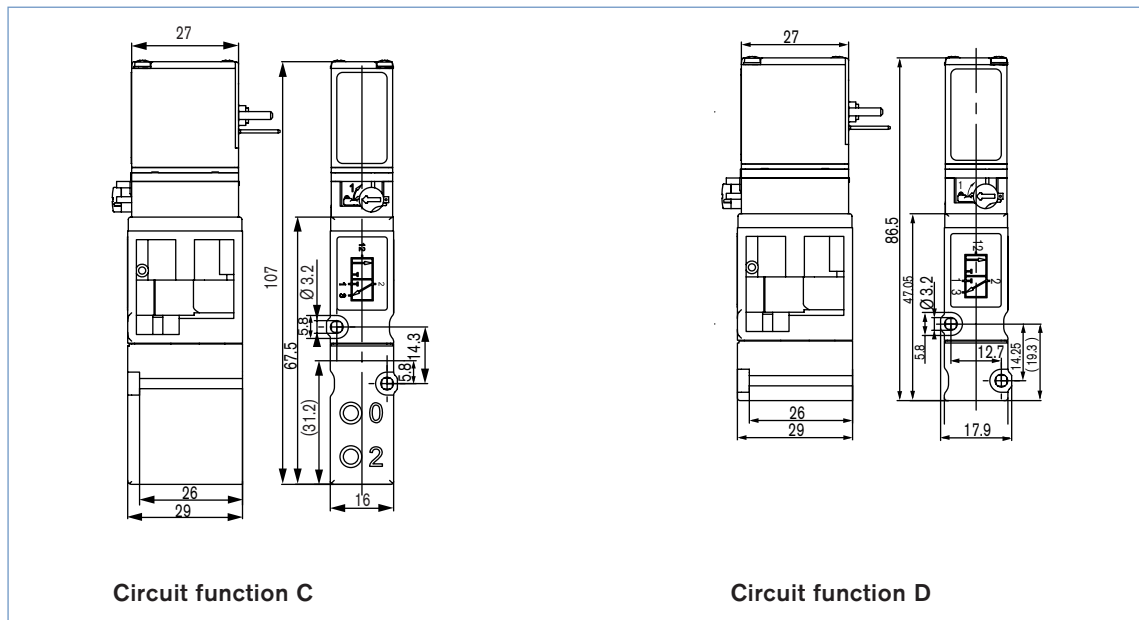

Application example

14 Actuators (process valves, cylinder) are controlled

8 double acting actuators (large volume)

6 double acting actuators (small volume)

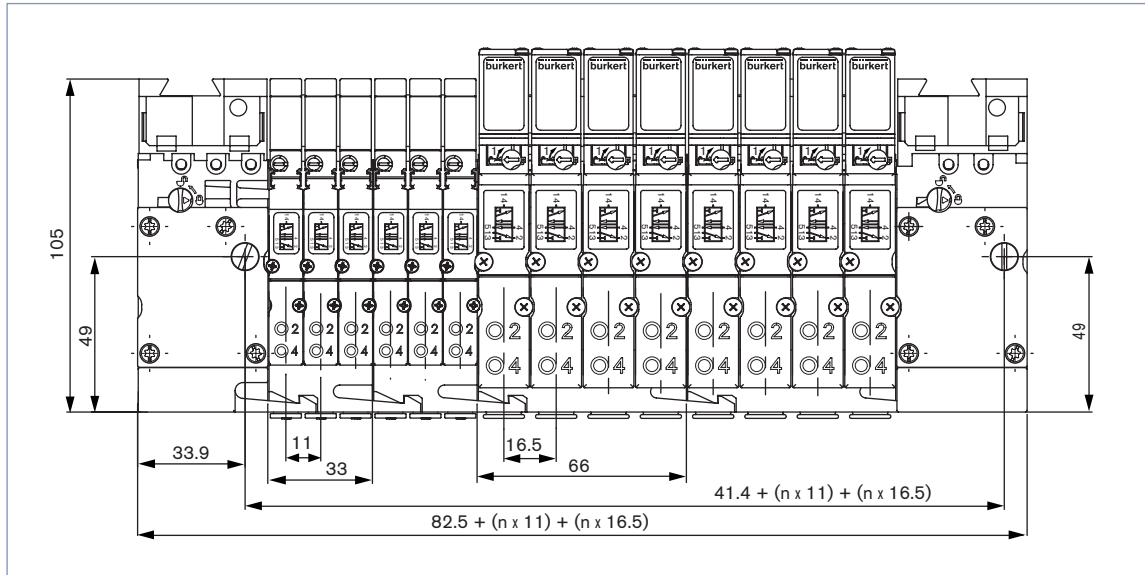

| Quantity | Type | Version | Item no. |
|----------|--------------------|---|----------|
| 1 | MP12 | Connection module, right G 3/8 | 655 110 |
| 2 | MP12 | Pneumatic basic module, 4 valves, push-in connection Ø 8 mm | 156 656 |
| 2 | MP12 for Type 6525 | Pneumatic basic module, 3 valves, push-in connection Ø 6 mm | 156 647 |
| 1 | MP12 | Connection module, left G 3/8 | 655 109 |
| 8 | 6527 | 5/2-way- valve, WWC, QNn 700 l/min | 156 827 |
| 6 | 6525 | 5/2-way- valve, WWC, QNn 300 l/min | 156 733 |

Sectional drawing

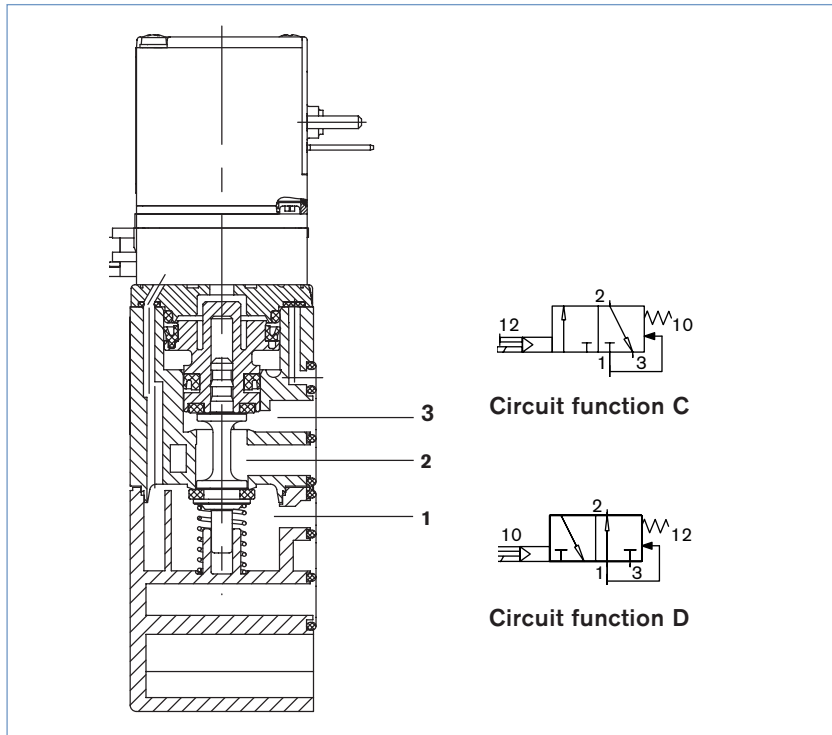

Ordering chart for accessories pneumatic modules Type MP12

| Built-in circuitry | Voltage [V] | Supply voltage | Item no. |
|----------------------------------|-------------|----------------|----------|
| without built-in circuitry | 0 - 250 V | DC | 008 353 |
| with LED | 12 - 24 V | DC | 008 402 |
| with LED and varistor | 12 - 24 V | DC | 008 408 |
| with rectifier, LED and varistor | 12 - 24 V | AC/DC | 008 354 |
| with rectifier, LED and varistor | 110 - 120 V | AC/DC | 008 355 |
| with rectifier, LED and varistor | 220 - 240 V | AC/DC | 008 356 |

Additional versions please see datasheets for Type 2506

The delivery of a socket connection includes the flat seal and the mounting screw. For other socket connection models with integrated circuitry to DIN EN 175301-803 (previously DIN 43650) Form C, see datasheet 2506.

